



Lindab Rainline™  
– the STEEL rainwater system



[www.lindab.co.uk](http://www.lindab.co.uk)

# This is Lindab

With more than 45 years of experience in the development, manufacturing and marketing of sheet-metal products, Lindab has become one of the leading international players in the construction and HVAC industries.

In 1957, Lindab started out as a small sheet-metal shop in Lidhult, Sweden and the year after Lindab moved to Båstad, at the Bjäre Peninsula in the south west of Sweden where Lindab is situated today.

Lindab has since then expanded to a world wide business with representation in 29 countries.



## Lindab's market presence

- 128 locations in 29 countries
- Local production units in 18 countries
- Over 1000 Lindab distributors cover Europe and eastern/central USA
- Employs over 5,000 people
- Head Office in the beautiful Bjäre Peninsula in the south west of Sweden

### IT COMES NATURALLY

Lindab's business is based on long-term sustainable and environmentally friendly systems in steel and sheet metal. We focus on minimizing the use of raw materials, components, energy, packaging, and transport. Today 90 percent of our operations are certified according to ISO 14001. A full environmental declaration is available on request.

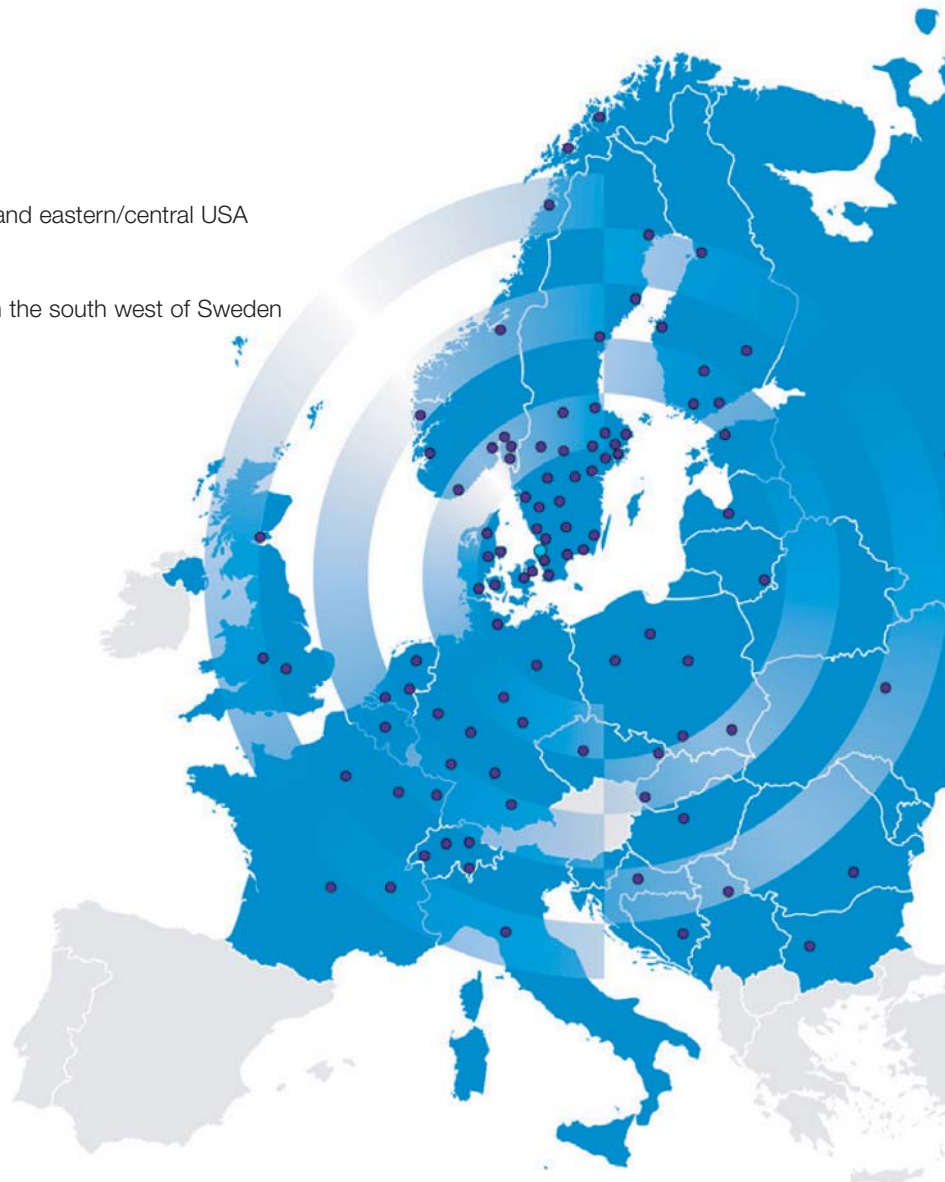

# The superior quality system

Lindab Rainline is the rain-drainage system that offers the highest quality when it comes to combining durability, flexibility and ease of installation.

Lindab Rainline has been developed by professionals and over time it has grown to become the top choice of tradesman and diy enthusiasts alike, due to its hard wearing properties which ensures decades of performance.

A policy of continual research and development, led in many instances by feedback from existing customers, has ensured that the Lindab Rainline system reflects the needs of the specifier, installer and end user.

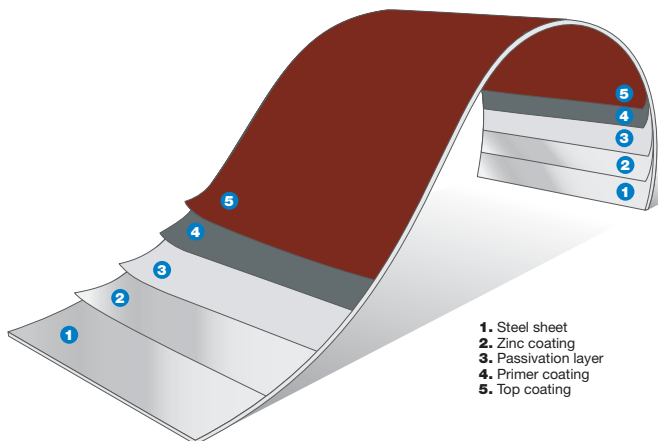

## Features and Benefits of Lindab Rainline

### Made to last

Steel is the ultimate material for roof-drainage systems. It is much lighter than cast iron, is easier to handle than aluminium and offers minimal thermal movement compared to plastic (which can move and crack causing leaks).

### Simplified construction

No specialist tools or skills are required, gutters and downpipes simply push together without the need for any sealants.

### Stylish design

Lindab Rainline offers solutions for a wide variety of buildings, large or small, classic or contemporary.

### Low maintenance

The only maintenance required is an occasional wipe or washdown. Easy assembly and installation guarantee a long service life.

### Vandal resistant

Highly resistant to attack from vandals - can be fixed flush to a wall to avoid means of climbing up downpipe.

### Colour choice

Available in a choice of 8 standard colours (high-build polyester paint finishes) as well as plain galvanized and Aluzinc-coated finishes. We can also provide custom colours if you are looking for a more individual look. Coated finishes are UV stable - will not fade or crack.

### 15 year guarantee

Lindab Rainline coated products all come with a standard 15 year guarantee and a further 5 years on the aluzinc range. The guarantee covers the whole system including the integrity of the steel itself.

### Minimum environmental impact

Lindab focuses on minimising the use of raw materials, components, energy, packaging and transport.

### Cost effective solution

Competitively priced to that of leading plastic systems and inexpensive compared with aluminium and cast iron systems.

# Choosing the right rainwater system has never been easier



## Smart bracket

This bracket can be adjusted to match any fascia board angle. Strong and extremely easy to fit.



## Stop ends

These ends are self-sealing with an EPDM tube. They are non-handed easily fitted with a single firm tap from a soft hammer.



## Pipe holder

This holder is made from one piece of sheet steel and mounts a pipe with one firm click and fixes with two screws.



## Gutter joint

These joints are easy to fit, creating a very firm and durable joint. The joints are guaranteed leak-proof with a long-lasting EPDM seal.



## Outlet

This versatile gutter outlet has a one-grip snap-on mounting that ensures a perfect fit to the semi-circular shape of the gutter. A minimum of a 2 inch dia hole needs to be drilled or cut out of the gutter before outlet is assembled.

## Extra durable high-build polyester paint finishes



**Antique White**  
RAL 9002



**Black**  
RAL 9005

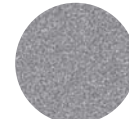

**Silver Metallic**  
RAL 9006



**Brown**  
RAL 8017



**Dark Grey**  
RAL 7011



**Copper Metallic**  
RAL 8003



**Tile Red**  
RAL 8004



**Dark Red**  
RAL 3009

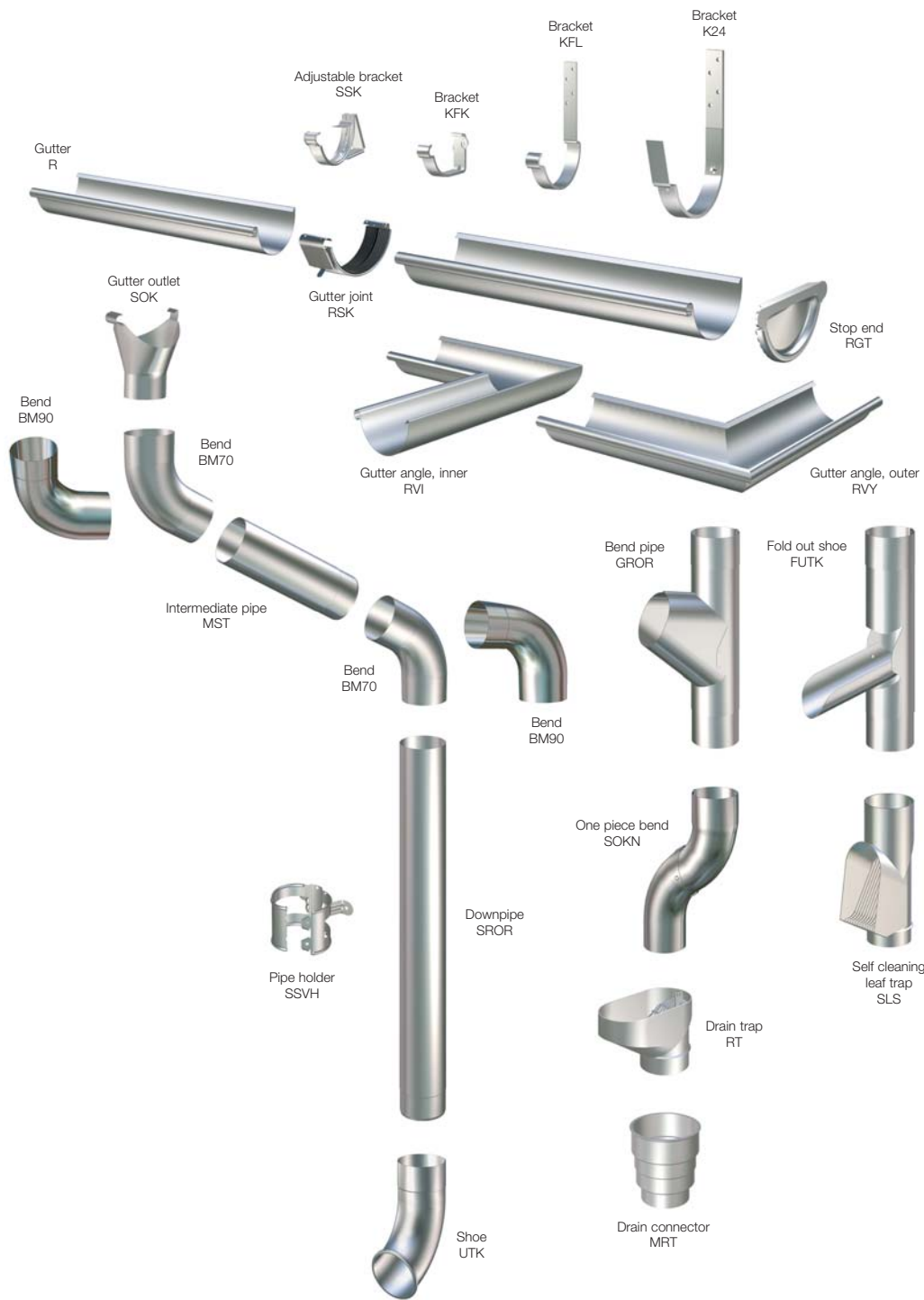

MAINTENANCE LIFECYCLE

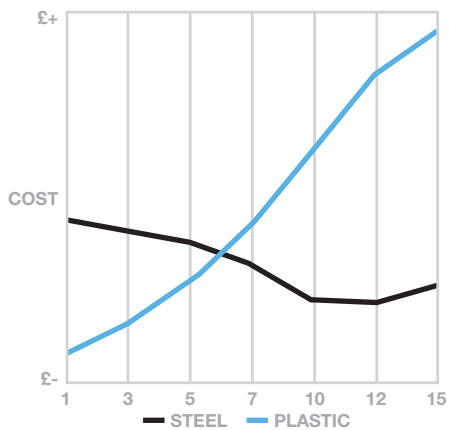

£ PRICE POSITIONING

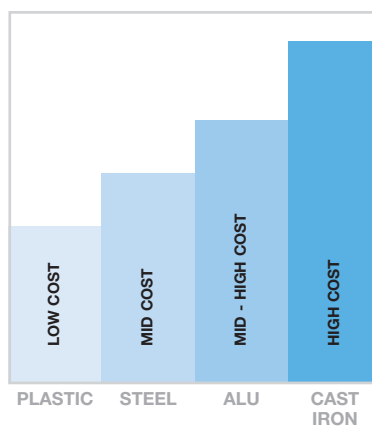

EXPANSION -5°C to +30°C

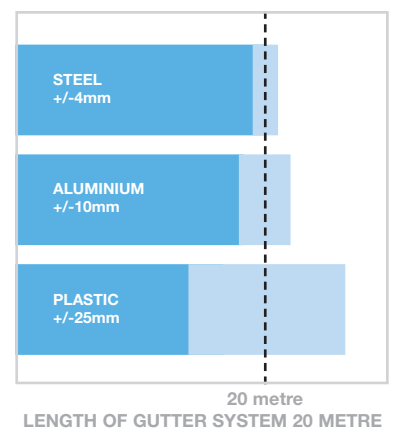

# Technical Facts **Half Round Gutter & Accessories**

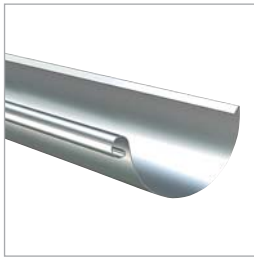

## R Half Round Gutter. Standard Length 3m

Size mm	D mm	d mm	Galv	Coated	Aluzinc
R100-3m	107	17	✓	✓	N/A
R125-3m	123	17	✓	✓	✓
R150-3m	155	17	✓	✓	✓
R190-4m	192	22	✓	✓	N/A

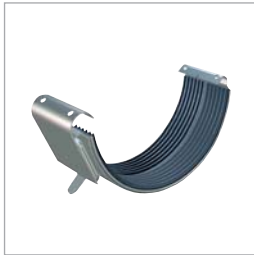
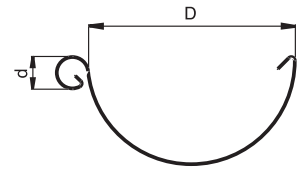

## RSK Gutter Joint with EPDM Rubber Seal

Size mm	Galv	Coated	Aluzinc
RSK-100	✓	✓	N/A
RSK-125	✓	✓	✓
RSK-150	✓	✓	✓

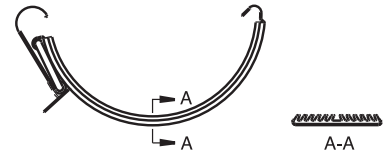

## KFK Fascia Bracket

Size mm	Galv	Coated	Aluzinc
KFK-100	✓	✓	N/A
KFK-125	✓	✓	N/A*
KFK-150	✓	✓	N/A*

\*Order in silver metallic

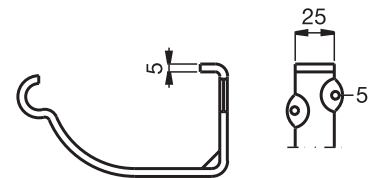

## K24 Fascia Bracket

Size mm	L mm	Galv	Coated	Aluzinc
K24-190	107	✓	✓	N/A

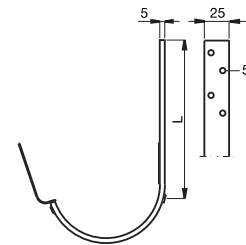

## SSK Adjustable Snap-On Bracket

Size mm	Galv	Coated	Aluzinc
SSK-100	N/A*	✓	N/A
SSK-125	N/A*	✓	N/A*
SSK-150	N/A*	✓	N/A*

\*Order in silver metallic

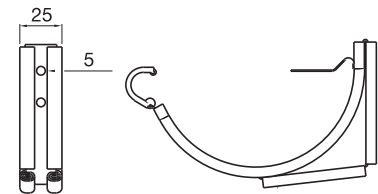

## KFL Rafter Bracket\*

Size mm	L mm	Galv	Coated	Aluzinc
KFL-100	196	✓	✓	N/A
KFL-125	196	✓	✓	N/A*
KFL-150	196	✓	✓	N/A*

\*Order in silver metallic

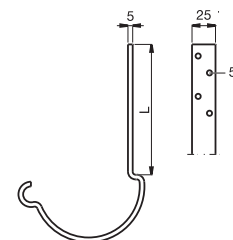

# Technical Facts **Half Round Gutter & Accessories**



## K33 Rafter Bracket

Size mm	L mm	Galv	Coated	Aluzinc
K33-190	337	✓	✓	N/A

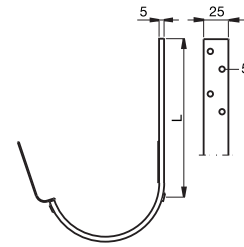

## RFKF Rise and Fall Bracket

Size mm	Thread mm	Spike mm	Galv	Coated	Aluzinc
RFKF-100	250	300	✓	✓	N/A
RFKF-125	250	300	✓	✓	N/A*
RFKF-150	250	300	✓	✓	N/A*

\*Order in silver metallic



## RGT Stop End, Self-Locking (Non-Handed) with EPDM Rubber Seal

Size mm	Galv	Coated	Aluzinc
RGT-100	✓	✓	N/A
RGT-125	✓	✓	✓
RGT-150	✓	✓	✓

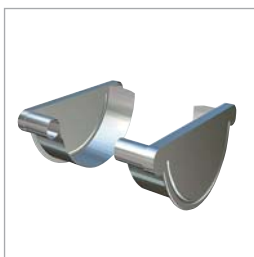
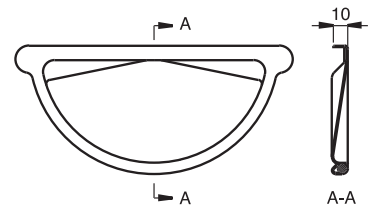

## RGV/RGH Stop End (Left/Right Handed)

Size mm	Galv	Coated	Aluzinc
RGV/H-190	✓	✓	N/A

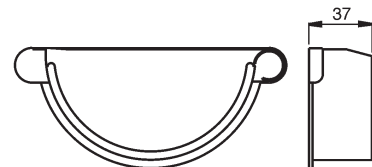

## RVI 90° Gutter Angle: Inner

Size mm	L mm	Galv	Coated	Aluzinc
RVI-100	400	✓	✓	N/A
RVI-125	400	✓	✓	✓
RVI-150	400	✓	✓	✓
RVI-190	500	✓	✓	N/A

\*135° angle 50% extra / special angles 100% extra. 2 jointers required per angle.

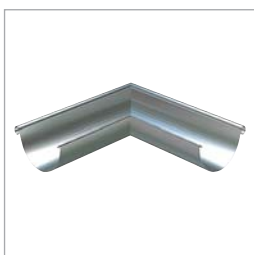
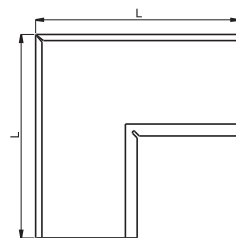

## RVY 90° Gutter Angle: Outer

Size mm	L mm	Galv	Coated	Aluzinc
RVY-100	295	✓	✓	N/A
RVY-125	275	✓	✓	✓
RVY-150	230	✓	✓	✓
RVY-190	285	✓	✓	N/A

\*135° angle 50% extra / special angles 100% extra. 2 jointers required per angle.

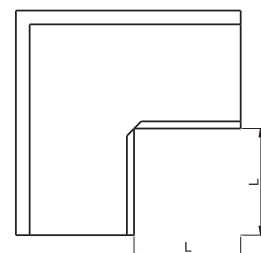

## Technical Facts **Half Round Gutter & Accessories**



### SOK Gutter Outlet

Size mm	A mm	Galv	Coated	Aluzinc
SOK-100	151	✓	✓	N/A
SOK-125	174	✓	✓	✓
SOK-150	207	✓	✓	✓
SOK-190	180	✓	✓	N/A

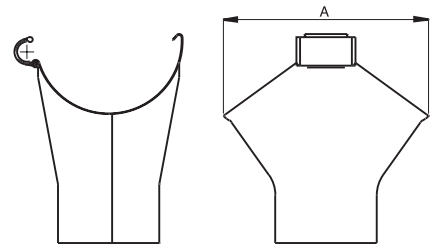

## Technical Facts **Down Pipe & Accessories**



### SROR Down Pipe: Standard Length 3m

Size mm	Galv	Coated	Aluzinc
SROR-75	✓	✓	✓
SROR-87	✓	✓	✓
SROR-100	✓	✓	✓
SROR-111	✓	✓	N/A
SROR-120	✓	✓	N/A

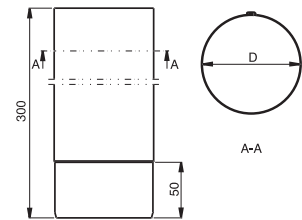

### SSVH Down Pipe Bracket

Size mm	Galv	Coated	Aluzinc
SSVH-75	✓	✓	✓
SSVH-87	✓	✓	✓
SSVH-100	✓	✓	✓
SSVH-111	✓	✓	N/A
SSVH-120	✓	✓	N/A

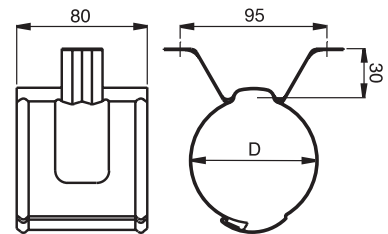

### MST Intermediate Pipe x 1m

Size mm	Galv	Coated	Aluzinc
MST-75	✓	✓	✓
MST-87	✓	✓	✓
MST-100	✓	✓	✓
MST-111	✓	✓	N/A
MST-120	✓	✓	N/A

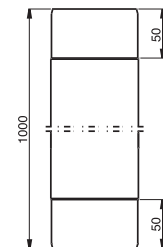

### MSTR Rod Access Pipe x 1m

Size mm	Galv	Coated	Aluzinc
MSTR-75	✓	✓	✓
MSTR-87	✓	✓	✓
MSTR-100	✓	✓	✓
MSTR-111	✓	✓	N/A
MSTR-120	✓	✓	N/A

Inspection door available in plain Galv as standard. Can be colour matched at extra cost.

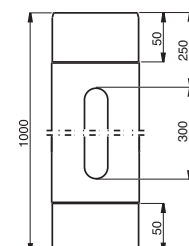

# Technical Facts **Down Pipe & Accessories**



## **BM 70° Pipe Bend** (2 bends per offset required)

Size mm	R mm	Galv	Coated	Aluzinc
BM70-75	90	✓	✓	N/A
BM70-87	100	✓	✓	N/A
BM70-100	125	✓	✓	N/A
BM70-111	115	✓	✓	N/A
BM70-120	125	✓	✓	N/A

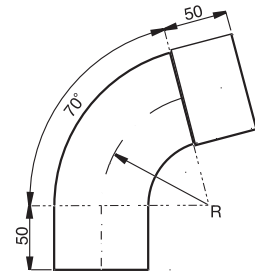

## **BM 90° Pipe Bend** (2 bends per offset required)

Size mm	R mm	Galv	Coated	Aluzinc
BM90-75	90	✓	✓	N/A
BM90-87	100	✓	✓	N/A
BM90-100	125	✓	✓	N/A

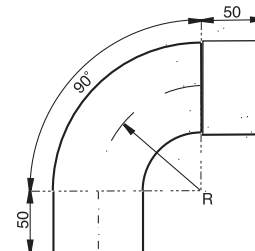

## **UTK Pipe Shoe**

Size mm	R mm	L mm	Galv	Coated	Aluzinc
UTK-75	105	165	✓	✓	✓
UTK-87	105	170	✓	✓	✓
UTK-100	105	175	✓	✓	✓
UTK-111	115	190	✓	✓	N/A
UTK-120	125	205	✓	✓	N/A

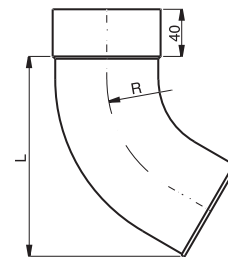

## **SRORM Pipe Connector**

Size mm	Galv	Coated	Aluzinc
SRORM-75	✓	✓	N/A*
SRORM-87	✓	✓	N/A*
SRORM-100	✓	✓	N/A*

\*Order in silver metallic

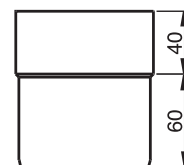

## **GROR Branch**

Size mm	Galv	Coated	Aluzinc
GROR-75	✓	✓	✓
GROR-87	✓	✓	✓
GROR-100	✓	✓	✓

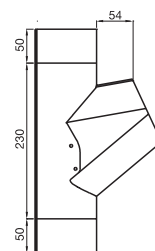

## **FUTK Adjustable Shoe (manual)**

Size mm	Galv	Coated	Aluzinc
FUTK-75	✓	✓	✓
FUTK-87	✓	✓	✓
FUTK-100	✓	✓	✓

\*automated rain water diverter available in plastic

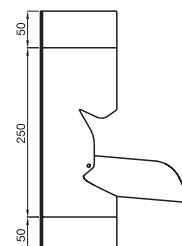

# Technical Facts **Down Pipe & Accessories**



## SOKN One Piece Bend

Size mm	Galv	Coated	Aluzinc
SOKN-75	✓	✓	✓
SOKN-87	✓	✓	✓
SOKN-100	✓	✓	✓

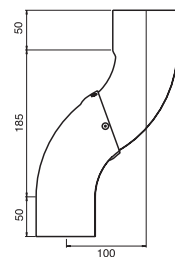

## VATK-R Small Rectangular Water Hopper

Size mm	Galv	Coated	Aluzinc
VATKR-75	✓	✓	N/A
VATKR-87	✓	✓	N/A
VATKR-100	✓	✓	N/A
VATKR-120	✓	✓	N/A

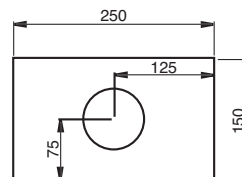

## VATK-L Large Square Water Hopper

Size mm	Galv	Coated	Aluzinc
VATKL-75	✓	✓	✓
VATKL-87	✓	✓	✓
VATKL-100	✓	✓	✓
VATKL-120	✓	✓	✓

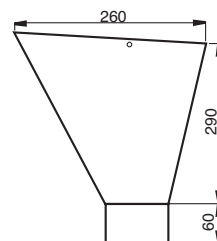

## RT Drain Trap for Down Pipes (HD polythene)

Leaf strainer. The lower section fits standard ground pipes/junction pipes.

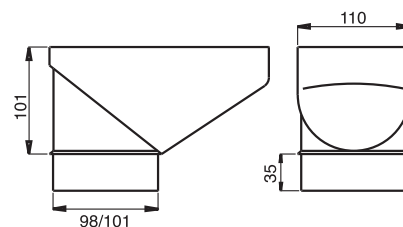

## SLS Self Cleaning Leaf Trap (HD polythene)

Self cleaning leaf strainer. The lower section fits standard ground pipes/junction pipes.

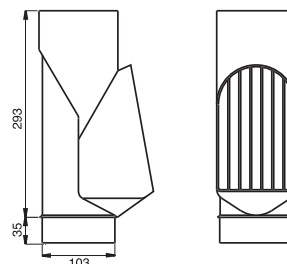

## MRT Drainage Connector (HD polythene)

Drainage adapter. For connection to ground pipes with other dimensions than standard.

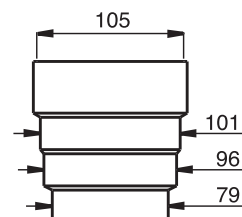

## Technical Facts **Accessories**

### Fixing Screws (50 per bag)

Colour	Size
Black & Galv finish only	4.8mm x 25mm

### Touch-Up Paint

Description
STIFT Touch-up paint .0121 litre
BF-250 Touch-up paint .250 litre

### Gutter Leaf Guard - Length 10M (HD polythene)

Description
Gutter Leaf Guard (23 clips included)
Additional clips can be ordered

### KBO Bracket Bender

Description
Bracket Bender

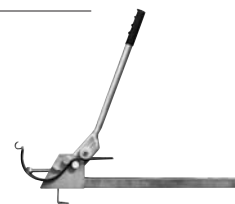

## Lindab Rainline™

– the high performance STEEL rainwater system



**Westlea Housing Association**  
Architect: *In-House*  
Project Location: *Groundwell, Swindon*



**Daymer Bay Company**  
Architect: *Harrison Sutton*  
Project Location: *Medrose, Rock, Cornwall*



**Totty Construction**  
Architect: *AFL Architects, Manchester*  
Project Location: *Wilmslow, Cheshire*

**Loved by builders, appreciated by planners and wanted by clients**



**Devon & Cornwall Housing Association**  
Architect: *Gale & Snowden*  
Project Location: *Oak Meadow, South Molton*



**Duke of Somerset Estates**  
Architect: *Harrison Sutton*  
Project Location: *Waterside Offices, Totnes*

**Gerald Wood Homes (Midas)**  
Architect: *Heighway Field Associates*  
Project Location: *Berry Pomeroy*



**Office support**

We have dedicated customer support at our UK Head Office in the Midlands which can provide you with technical assistance, quotes, order entry and problem solving solutions just by picking up the phone. Send us your building drawings and we will even do a "product take-off" for you free of charge.

**Field Support**

We have a dedicated team of Area Managers who have been trained to the highest degree on our Rainwater System. Our team are available to visit you either on site or in your office/premises. We will give you full technical support on site and work closely with your designated contractor. Our team can also offer product demonstrations / seminars / CPD's at your place of work to enable you to make the right choice.

**Distribution**

We can normally deliver standard items to you within 3-5 working days. Deliveries are made directly from our distribution centre in the Midlands. We also have a database of approved distributors across the UK which can help you with orders, quotes and arranging visits from our Area Managers.

For more information about our product range or to find your nearest stockist please do not hesitate to contact us.

We are always close at hand to give you advice and assistance

At Lindab Building Products, our aim is to match the reliability of our products with that of our service. Customer support is a core part of our business philosophy.

We are proud of the relationships we have developed with local authorities, housing associations, exclusive developers, contractors and end users across the UK. We have only done this by adopting the right approach to both customers and end users.



**Lindab Ltd Building Products Division**

Shenstone Trading Estate  
Bromsgrove Road  
Halesowen  
West Midlands  
B63 3XB

Tel: (0121) 585 2780  
Fax: (0121) 585 2782  
Email: [buildingproducts.sales@lindab.co.uk](mailto:buildingproducts.sales@lindab.co.uk)  
Web: [www.lindab.co.uk](http://www.lindab.co.uk)



[www.lindab.co.uk](http://www.lindab.co.uk)

© 2007 Lindab AB. Lindab is a registered trademark of Lindab AB, as are the designation of our product ranges. Lindab AB reserves the right to make alterations without prior notice.

Whilst every care has been taken in the preparation of this brochure, some changes may have occurred since publication. Lindab Ltd is not responsible for omissions or typographical errors.