



# Air Valve

LAVN



## Description

A metal supply air valve is used in ventilation systems to control the flow of fresh air into a room or space. Made from strong, durable metal, it helps ensure even air distribution and improves indoor air quality.

## Dimensions

Icode	ØA(mm)	ØB(mm)	ØH(mm)	C(mm)
AVN100	145	126	67	18
AVN125	175	162	76	19
AVN160	218	199	80	20

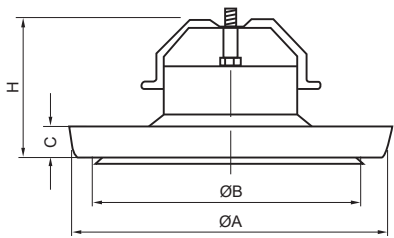

## Technical Data

**Material:** Valve body made from SPCC with a galvanized steel mounting ring for enhanced strength and corrosion resistance.

**Finish:** Durable powder-coated in RAL 9010, RAL 9016

**Seal:** Fitted with a cellular plastic gasket to provide a secure, airtight seal.

**Airflow Control:** Airflow can be easily regulated by rotating the control disc.