



Backdraught Shutter

LRSK



Description

Backflow draft damper for round ducts, made of galvanized steel sheet. The damper wings (swinging) are closed by a spring, which enables installation in any position. Used to allow flow of air in one direction only.

Dimensions

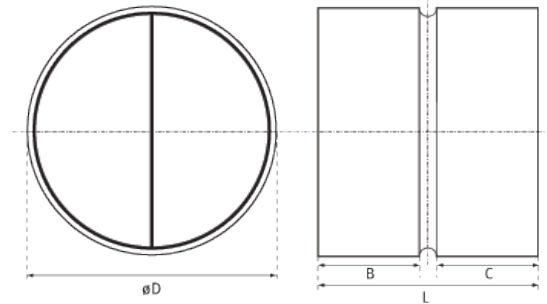

Symbol	øD [mm]	L [mm]	B [mm]	C [mm]
100	100	88	38	38
125	125	88	38	38
150	150	88	38	38
160	160	88	38	38
200	200	88	38	38
250	250	128	59	59
315	315	128	59	59
400	400	197	75	75

Pressure Lost Diagram

